

OCTOBER 2015

Better  
Homes  
and Gardens

AS  
SEEN  
ON



# serve it up

Open up your kitchen and create a colourful courtyard with an exotic flavour

**M**ake your courtyard the most used part of your home with this Moroccan-inspired makeover. Begin by improving how the whole space works with a bi-fold window and handy servery bench to connect kitchen and courtyard. Then banish the bricks with a rendered finish and paint to create a light, airy atmosphere. Excitement comes from vibrant feature colours and a sprinkling of flowers throughout. To finish, add texture using a wide variety of foliage and ornaments.



BEFORE



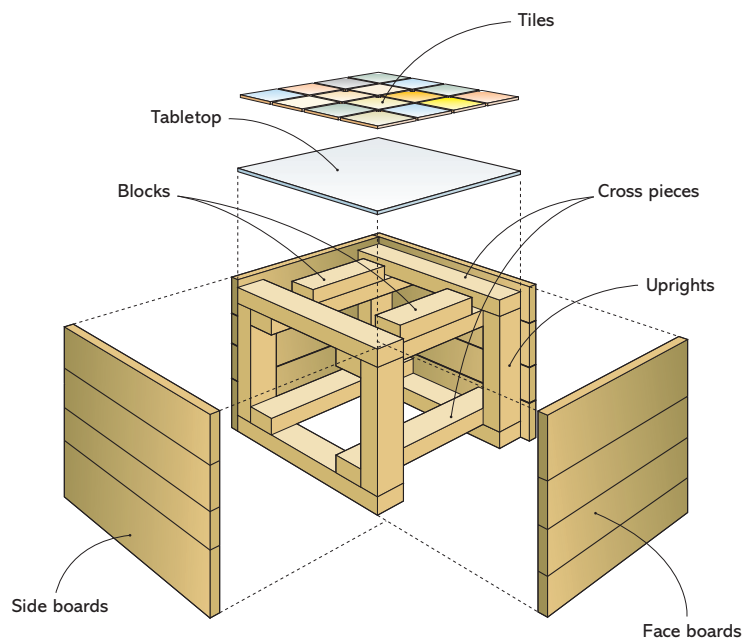

## Project 1

### SIDE TABLES

Combine the rough charm of recycled timber with the bright colours and patterns of hand-painted tiles to create an interesting addition to your courtyard makeover.

#### Gather your supplies

- 440 x 70 x 45mm treated pine cross pieces (8 per table)
- 380 x 70 x 45mm treated pine uprights (4 per table)
- 440mm x various widths and thicknesses recycled timber face boards
- 480mm x various widths and thicknesses recycled timber side boards
- 300 x 70 x 45mm treated pine blocks
- 440 x 440 x 4.5mm fibre cement sheet tabletop

#### You'll also need

Nail gun and nails for timber; fibre cement nails; hammer; selected tiles; tile primer; 6mm notched trowel; tile adhesive; ready-mixed grout; grout sponge; sponge; cloth

*Note* Adjust height of table to suit combined widths of recycled timber.



1. Pretty tiles and weathered timber come together in these gorgeous side tables. Make your own at home with this project.





STEP 1



STEP 2



STEP 3



STEP 4



STEP 6



STEP 7



STEP 8

**Here's how**

**STEP 1** Construct a rectangle by butting uprights into cross pieces flush with ends and nailing together. Repeat to construct a second rectangle.

**STEP 2** Stand rectangles and nail 1 cross piece to join them in corners flush with outside of rectangles. Repeat to place cross pieces in all 4 corners of rectangles to create a table frame.

**STEP 3** On one 470mm high side, nail 1 face board so it overhangs adjacent side by 20mm. Lay rest of face boards on this side. Repeat on opposite face of cube ensuring boards overhang on same side.

**STEP 4** Attach side boards to frame so they cover ends of face boards.

**STEP 5** On side of frame where boards overhang, nail blocks between cross pieces to support table top.

**STEP 6** Nail tabletop on frame with fibre cement nails, using a hammer.

**STEP 7** Use primer to prepare tabletop for tiles. Let dry then use notched trowel to apply adhesive. Press tiles into adhesive, keeping gap between each equal. Leave to set.

**STEP 8** Use grout sponge to fill gap between tiles with grout. Wipe off excess with damp sponge, rinsing frequently. Leave grout to set then polish tiles with dry cloth.



## Project 2

### DOOR DRESS-UP

To update a plain old door, you don't have to splash out. A few lengths of timber moulding and a lick of paint will give it a brand new look.

#### Gather your supplies

- 19mm tri-quad moulding
- 66 x 18mm primed pine
- 90 x 18mm primed pine
- 30 x 12mm treated pine

#### You'll also need

Power saw; PVA glue; 30mm nails; drill, bit and screws; wood filler; Dulux 1 Step Primer Sealer & Undercoat; Dulux Super Enamel Semi Gloss (we used Riviera Sea)

#### Here's how

**STEP 1** Cut lengths of tri-quad with mitres in each corner to make a rectangular shape on door. Make sure gap from shape to door frame is equal all around door. Glue and nail top, bottom and 1 side to door.

**STEP 2** Cut tri-quad with 45° angles at each end to fit neatly between top and bottom pieces. Place in centre of top and nail at top only.

**STEP 3** Mark side for short cross pieces so they are evenly spaced. Cut cross piece with angled ends to fit between side and centre piece. Butt cross piece into side and make level. Nail in place. Push centre piece into cross piece so join is neat and nail centre piece at join. Repeat to fix rest of cross pieces and centre piece down this side of door.

**STEP 4** Nail other side piece to door at top only. Repeat Step 3 to fix cross pieces and side piece down this side of door.

**STEP 5** Measure from door frame to surrounding brickwork at various points around door. Take largest measurement and use power saw to rip down 66mm timber to this width. Cut to make a timber reveal that will sit around the door.

**STEP 6** Use 90mm-wide timber as an architrave that will sit on reveal. Leave a 5mm gap to the inside of reveal and mitre corners. Nail in place. Place architrave and reveal assembly against door. Screw through reveal into door frame to secure.

**STEP 7** In centre of each square on door, glue and nail a small piece of 30mm-wide treated pine as a feature.

**STEP 8** Fill all nail holes and gaps, then apply Dulux 1 Step and let dry before applying 2 coats of semi gloss enamel in your selected colour, allowing to dry between coats.



steps

BEFORE







## Project 3

### SERVERY WINDOW AND BENCHTOP

#### Gather your supplies

- Bi-fold window to suit opening (see box on Ordering Your Window below right)
- Benchtop material (we used laminated bamboo in a variety of widths)
- Architrave in profile to match existing
- Timber storm moulds (if required)

#### You'll also need

Utility knife; broad chisel; multi-tool or mini-hacksaw; lump hammer; bolster; reciprocating saw or handsaw; straightedge and clamp; power saw; drill and 35mm Forstner bit; wood chisel; PVA glue; bench top joiners and spanner to suit; 50mm wood screws; fine-grit sandpaper; 7 x 85mm galvanised steel bars (3) for servery supports; construction adhesive; 25mm hex head screws; plastic packers; jigsaw; builder's masking tape; silicone; kitchen timber oil; stain applicator; Mastertouch Carnuba Wax; fine (0000 grade) steel wool; exterior timber finish

*Note* This window is undercover and not exposed to the elements, so has been installed without flashing. Windows in an exposed position should be suitably flashed to prevent water entry.

#### Here's how

**STEP 1** To remove existing window, remove architraves on inside. Use sharp utility knife to cut paint between architrave and wall, then pry off with broad chisel.

**STEP 2** Window is held in place by nails through timber reveals on window into the house frame, so slip a powered multi-tool or



**3. Give 'em a serve!** Outdoor entertaining is a breeze with a kitchen servery. It's the perfect link from inside to out.

### steps



#### ORDERING YOUR WINDOW

To order your new window, measure between the bricks on either side of the opening to get the width. Allow a couple of millimetres' gap on each side to make installation easier. To get the height, measure from the inside of the reveal at the top of the window down to the benchtop and make sure you order the window without any timber attached to the sill. Also, measure the width of the reveal so the new window will match it.



mini-hacksaw into gap between window and frame to cut through these nails.

**STEP 3** When window is loose, carefully remove it from opening.

**STEP 4** Have tradesmen disconnect and remove sink, taps and cooktop. Use utility knife to cut and remove silicone between benchtop and splashback. Unscrew benchtops from cabinets. Slide benchtop out from under splashback material to avoid damage. Benchtop may need cutting into pieces to remove.

**STEP 5** Using lump hammer and bolster, demolish exterior brick sill to bring wall height below benchtop level inside.

**STEP 6** Pry sill piece from timber frame and retain. Transfer level of kitchen cabinets to timber studs in wall. From this point, measure down stud 52mm (45mm for thickness of sill piece and 7mm for steel servery supports) and square a line across it. Using reciprocating saw or handsaw, cut through timber studs along this line. Reinstall sill piece and nail into studs.

**STEP 7** To prepare cabinets for servery supports to be installed later (see Step 14), cut three 90mm wide slots in back of cabinets flush with top of sill piece. Have a slot at each end and 1 in the centre of servery opening.

**STEP 8** Measure and mark benchtops for cutting using existing benchtops as a guide. Where benchtop extends into servery, make back edge of benchtop sit under window. To cut benchtops, clamp straightedge to them as a guide for power saw, making sure blade is on cutting line. Check benchtops for fit and adjust if required. Where they join, make sure edges of benchtop are square.

**STEP 9** To set out for joiners on undersides of benchtops, mark points 100mm in from each side and in centre of join on each benchtop. For wide benchtops allow for 2 joiners equally spaced between those on each side. At each point mark 40mm in from edge. This is centre of holes needed for joiners.

**STEP 10** Using drill fitted with 35mm Forstner bit, drill 25mm deep holes at each position for benchtop joiners.

**STEP 11** Using sharp chisel, cut and remove a 10mm wide channel from edge of benchtop to hole. Channel should be in centre of hole and same depth as it.

**STEP 12** Place benchtops on cabinets and slide under splashback tiles. Spread PVA glue along where they join and bring together. Place benchtop joiners in holes drilled for them and use spanner to tighten. Ensure front edge and

## Blur the line between inside and out!



STEP 3



STEP 9



STEP 4



STEP 10



STEP 5



STEP 11



STEP 6

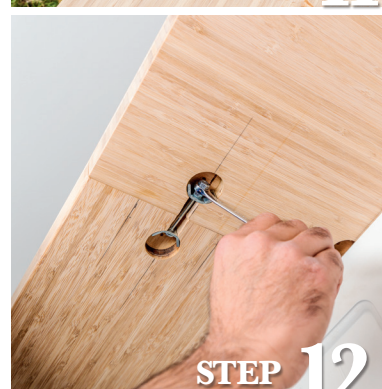

STEP 12



top of benchtop are flush. Repeat for all joins and allow glue to dry.

**STEP 13** Attach benchtops through top of cabinets using 50mm screws. Sand top of benchtop to remove residual glue and make smooth.

**STEP 14** Drill 8mm holes in ends of servery support bars to allow for screws. Slide bars into slots cut in cabinets in Step 7. Make overhanging end sit 50mm in from where edge of servery will be. Using 25mm hex head screws, attach bars to underside of benchtop. Cut timber blocks to fit between bars and bricks below. Use construction adhesive to glue in position so they are flush with face of brickwork.

**STEP 15** Cut servery bench to size and slide into opening so it sits on support bars. Screw up through bars into benchtop to secure.

**STEP 16** Place new window into opening. Make level and ensure edge of timber reveal is flush with wall lining. Screw through top and bottom of reveal into wall frame, using plastic packers between reveal and frame to hold window in position.

**STEP 17** Cut and install timber storm moulds to fit in any gaps around outside of window. Also nail a strip of timber under servery bench to hide gap to brickwork.

**STEP 18** Finish installation with new architraves. Leave a 5mm gap to inside edge of reveal. Mitre corners and rebate back of architrave to fit around tiles if required. Nail into reveal and timber wall framing.

**STEP 19** Place templates supplied with sink and cooktop in correct positions on benchtop and trace around them. Using jigsaw, cut out shapes. Have tradesmen return to reconnect sink, tap and cooktop.

**STEP 20** Run masking tape along either side of join between benchtop and other elements such as splashback, window and architraves. Apply silicone to join, smoothing off with a finger dipped in soapy water. Remove tape and leave to cure.

**STEP 21** Using stain applicator, finish benchtop in kitchen grade timber oil, following product instructions. For extra protection, apply natural furniture wax to tops with fine steel wool. On servery bench, apply 2-3 coats of suitable exterior timber finish following product instructions.

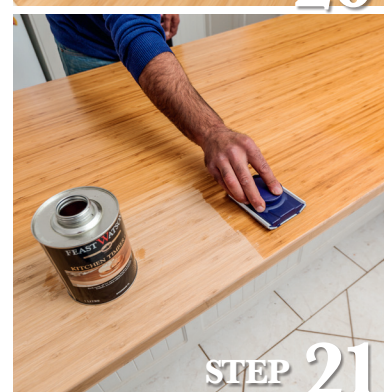





**4. Spruce up the area** next to the courtyard with new turf and a rustic iron tree seat. Plants under the seat brighten up an otherwise bare area.

*Project 4*

**TREE SEAT AND TURF**

Bare or patchy lawn is such an eyesore, but laying fresh turf and planting a sweet garden bed nearby easily fixes that! And if you have a tree in the middle of your lawn, consider placing a rustic bench around the tree, so you can sit and enjoy your new space.

**Gather your supplies**

- Rolls of turf
- Turf soil underlay
- Selection of annuals
- Rustic bench (ours was Marquee rustic iron surround bench)

**You'll also need**

Square-mouthed sharp spade; measuring tape; set-out paint; rake; sharp knife, improved garden soil or garden mix; mulch

**Here's how**

**STEP 1** Remove weed mat, if required. Use shovel to remove any patches of lawn or weeds. Place bench in position. Using measuring

tape and set-out paint, mark out a circle 50cm away from bench.

**STEP 2** Spread 5–10cm deep layer of turf soil underlay over area, avoiding marked circle, and rake evenly over surface. Compact turf soil underlay lightly by stepping on it.

**STEP 3** Lay a header course of turf around perimeter of area. Lay around circumference of marked circle, using sharp knife or spade to cut to fit around edges.

**STEP 4** Spread improved garden mix around base of tree, keeping it away from trunk. Plant up area with selection of plants, then water in and mulch well.

**steps**



**STOCKISTS**

Power tools, **Bosch Australia 1300 307 044, bosch.com.au** 900 x 85 x 7mm galvanised flat bar, \$15.12 each; 12g x 25mm hex head screws, \$3.68/15pk; Dunlop 800g ready to go grout, \$10.90; Dunlop primer additive, \$16.90/1L; 19mm tri-quad moulding \$6.74/2.4m; Dunlop acrylic render, \$12.50/20kg; Haven garden lantern 30cm, \$16.98; Haven garden lantern 8 x 13cm square, \$4.68; Haven garden lantern 8 x 13cm round, \$4.68; Marquee rustic iron bench 86cm, \$229, **Bunnings (03) 8831 9777, bunnings.com.au** Dulux Low Sheen Weathershield in Template Half and Template Quarter, **Dulux 13 25 25, dulux.com.au** Decorative tiles, **Old World Tiles oldworldtiles.com.au** Rubbish removal, **Dats Skip Bins 1300 003 287 dats.net.au**

PRICES ARE APPROXIMATE AND INTENDED AS A GUIDE ONLY